

SIMPLE MACHINES DELUXE[™]

**PULLEYS
POLEAS
POULIES**

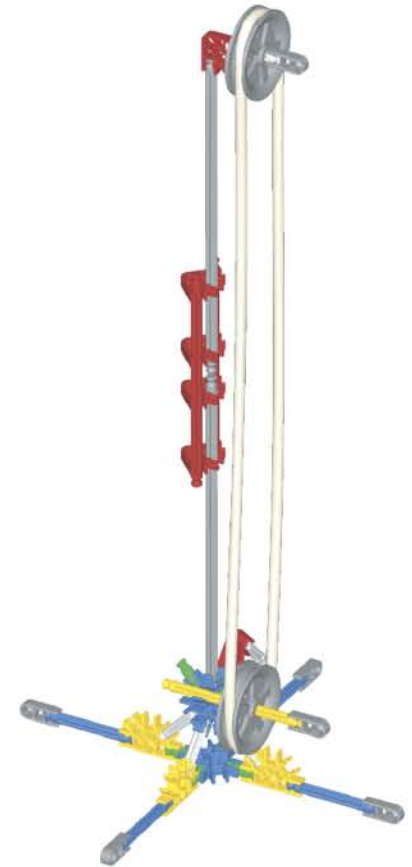
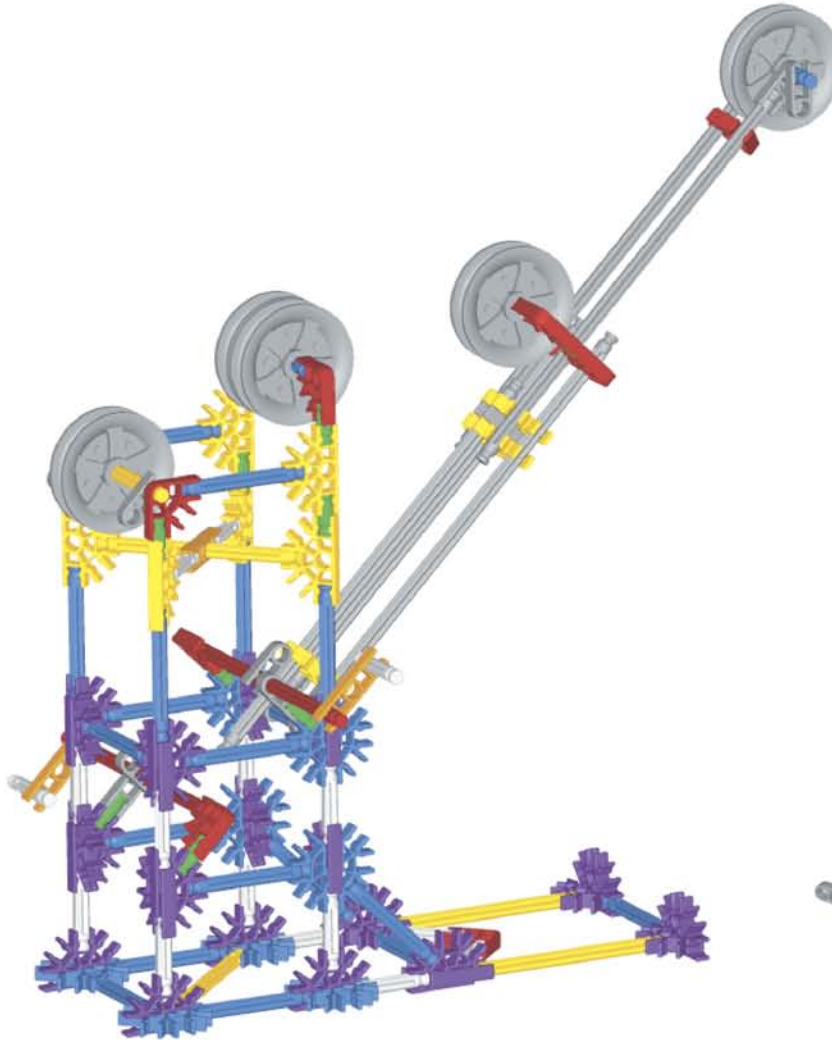

⚠ WARNING:

CHOKING HAZARD - Small parts.
Not for children under 3 years.

⚠ ADVERTENCIA:

PELIGRO DE ASFIXIA - Piezas pequeñas.
No es para niños menores de 3 años.

⚠ AVERTISSEMENT :

DANGER D'ÉTOUFFEMENT - Pièces de petite taille.
Ne convient pas aux enfants de moins de 3 ans.

GRADES
GRADOS
ANNÉES
3-9

8+

EN CONTENTS

| | |
|--------------------------|----|
| Pulley Stand | 3 |
| Fixed Pulley | 4 |
| Movable Pulley | 5 |
| Combination Pulley | 6 |
| Flagpole | 7 |
| Sailboat | 8 |
| Clothesline | 9 |
| Elevator | 10 |
| Block & Tackle | 13 |
| Crane | 17 |

ES CONTENIDOS

| | |
|----------------------------|----|
| Poleas soporte | 3 |
| Polea fija | 4 |
| Polea móvil | 5 |
| Polea de combinación | 6 |
| Varilla | 7 |
| Velero | 8 |
| Tendedero | 9 |
| Ascensor | 10 |
| Aparejo de poleas | 13 |
| Grúa | 17 |

FR CONTENUS

| | |
|-------------------------|----|
| Poulies stand | 3 |
| Poulie fixe | 4 |
| Poulie déplaçable | 5 |
| Poulie combinée | 6 |
| Mât de drapeau | 7 |
| Bateau à voile | 8 |
| Corde à linge | 9 |
| Ascenseur | 10 |
| Bloc et palan | 13 |
| Grue | 17 |

⚠ WARNING: CHOKING HAZARD - Small parts.
Not for children under 3 years.

CAUTION: Keep hair, clothing and fingers away from moving parts.

⚠ AVERTISSEMENT : DANGER D'ÉTOUFFEMENT -
Petites pièces. Ne convient pas aux enfants de moins
de 3 ans.

ATTENTION : Gardez les pièces mobiles à l'écart des
doigts, des vêtements et des cheveux.

⚠ ADVERTENCIA: PELIGRO DE ASFIXIA -
Piezas pequeñas. No es para niños menores de 3 años.

PRECAUCIÓN: Mantén el pelo, la ropa y los dedos
alejados de las piezas móviles.

⚠ CAUTION: Rubber Bands can cause injury
from snap-back, breaking, or loss of control.
While assembling models shown in instructions,
hold Rubber Band tightly, and do not overstretch.
Use Rubber Bands only as shown in these instructions.
DO NOT USE FRAYED OR TORN RUBBER BANDS.
Caution: Keep Rubber Bands away from face and eyes.

⚠ PRECAUCIÓN: Las gomas pueden causar
daños si se sueltan con fuerza, se rompen o se pierde
su control. Al construir los modelos que se muestran
en las instrucciones, sujetar bien la goma y no estirla
demasiado. Las gomas deben usarse únicamente como
se indica en las instrucciones. **NO USAR GOMAS QUE
ESTÉN DESGASTADAS NI RASGADAS.** Precaución:
Mantenga las gomas elásticas alejadas de la cara y los
ojos.

⚠ ATTENTION : Les élastiques peuvent causer
des blessures en claquant, en se cassant ou quand
on les manipule imprudemment. Tenez fermement
l'élastique lors de l'assemblage du modèle en veillant
à ne pas trop le tendre. N'utilisez les élastiques que
selon les instructions. **N'UTILISEZ PAS D'ÉLASTIQUES
ÉRAILLÉS OU DÉCHIRÉS.** Attention : Tenez les
élastiques en caoutchouc à l'écart du visage et
des yeux.

Each K'NEX piece has its own color and shape;
match it to pieces in the picture instructions.
Put pieces together exactly as pictures show.
Be sure to put rods in the correct slots of
connectors, so you have proper angles in
your finished model.

Assurez-vous de bien assembler les tiges dans
les fentes des connecteurs afin d'obtenir des
angles corrects une fois le modèle fini.
Asegurarse de colocar las varillas en las
ranuras correctas de los conectores, de modo
que al terminar el modelo, los ángulos sean los
adecuados.

Chaque pièce K'NEX a une couleur et une forme
bien à elle. Faites correspondre et montez les
pièces les unes sur les autres en suivant exactement
les instructions illustrées. Assurez-vous de bien
assembler les tiges dans les fentes des
connecteurs afin d'obtenir des angles corrects
une fois le modèle fini.

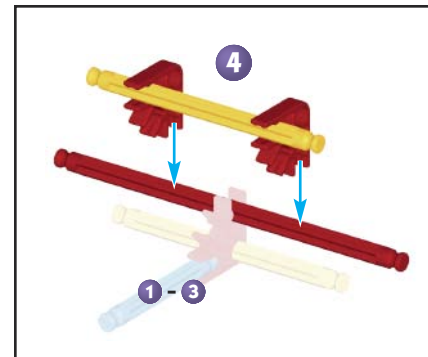
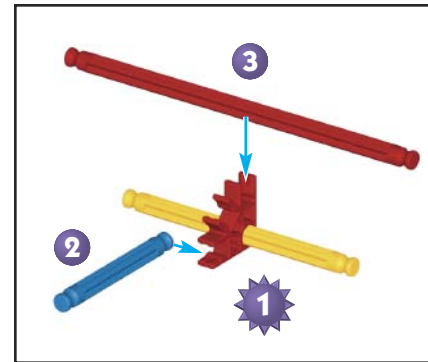

You can slide these special connectors
together. Push tightly until you hear a "click".
Pay close attention to the instructions and
position them horizontally or vertically exactly
as they are shown.

Se puede juntar estos conectores especiales
deslizándolos. Empujar ligeramente hasta oír
un "clic". Hace falta prestar mucha atención a
las instrucciones y posicionar los conectores
horizontal o verticalmente exactamente tal
como se muestran.

Les connecteurs bleus et gris ont une longue
encoche spécialement conçue pour s'emboîter
les unes dans les autres, tel qu'illustré. Bien les
pousser ensemble jusqu'à ce qu'un dé clic se
fasse entendre.

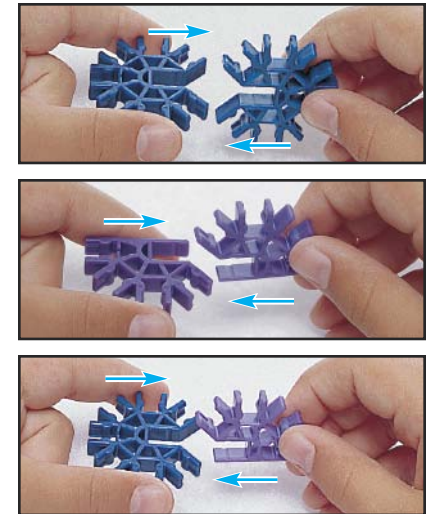

Faded colors indicate sections previously built;
connecting points will be in full color.

Los colores apagados indican secciones que ya han
sido montadas anteriormente. Los puntos de
conexión se indican con colores vivos.

Les couleurs plus claires indiquent les sections
déjà construites. Les points de jonction sont
indiqués en couleurs vives.

Pulley Stand

Poleas Soporte

Poulies Stand

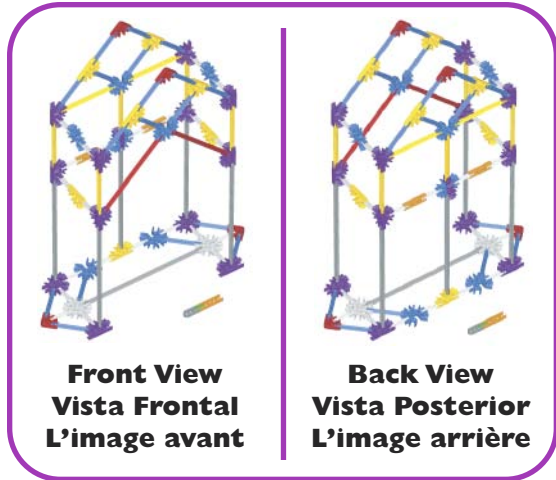
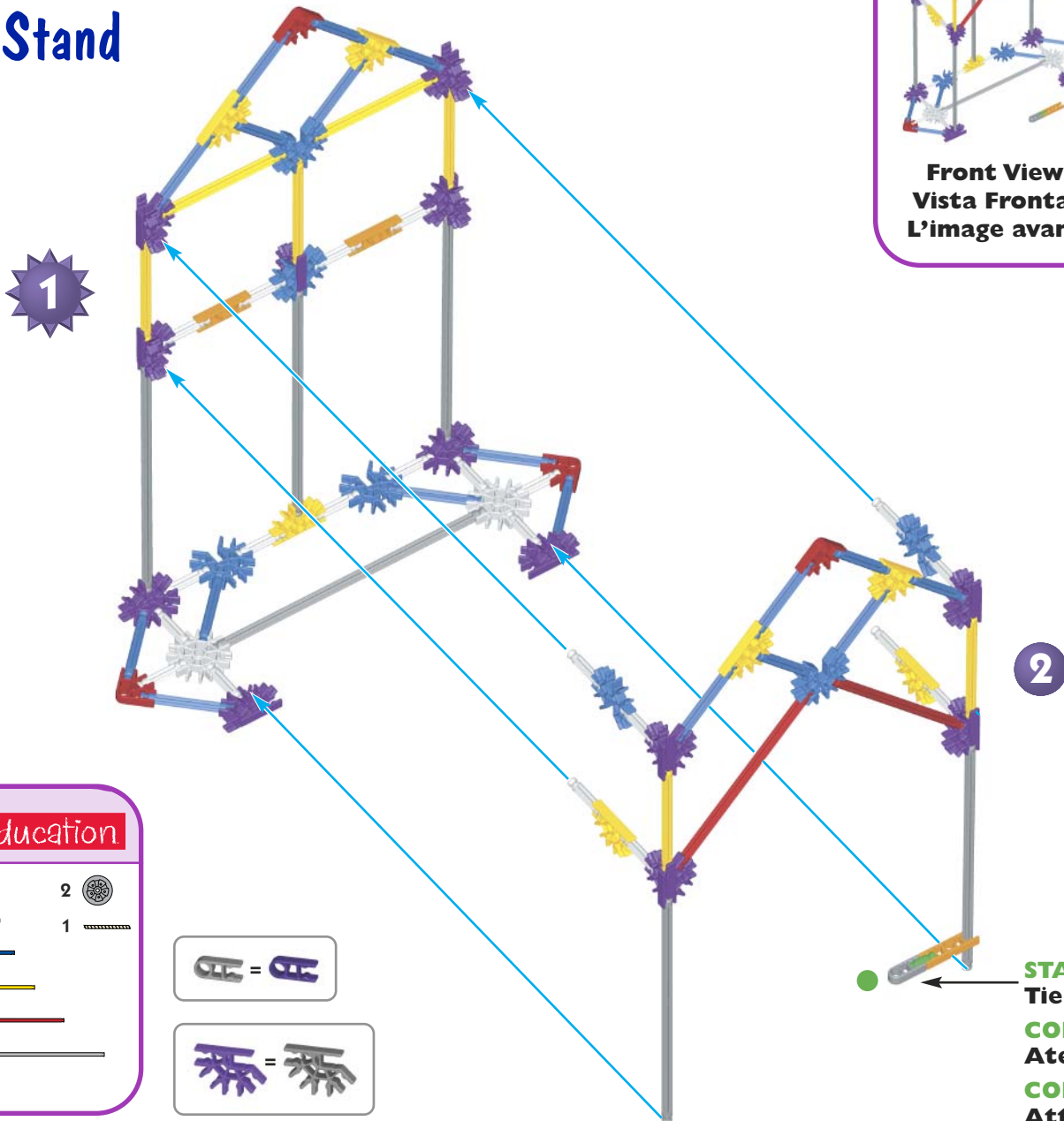

Front View
Vista Frontal
L'image avant

Back View
Vista Posterior
L'image arrière

1 - 2

K'NEX Education

| | | | |
|----|----|---|--|
| 8 | 4 | 2 | |
| 4 | 24 | 1 | |
| 8 | 18 | | |
| 7 | 7 | | |
| 25 | 2 | | |
| 7 | 8 | | |
| 2 | | | |



2

START
Tie cord here
COMENZAR
Ate el cable aqui
COMMENCER
Attacher la corde ici

Fixed Pulley

Polea Fija

Poulie Fixe

Note: Use the **back view** of the Pulley Stand to work with the Fixed Pulley.

Nota: Use the **vista posterior** del soporte de la polea para trabajar con la polea fija.

Note : Utiliser **l'image arrière** de la longueur de poulie pour travailler avec une poulie fixe.

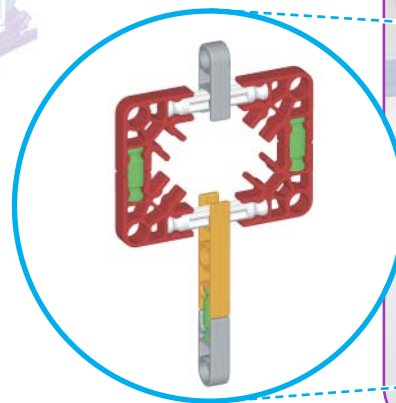
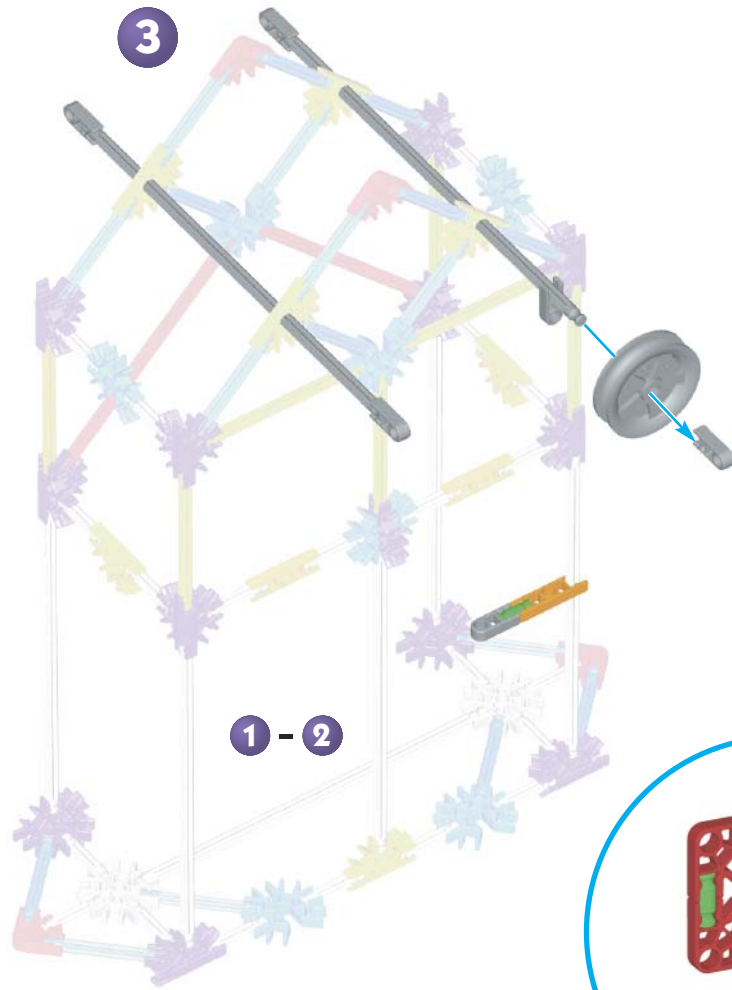

FINISH
Tie cord here
TERMINAR
Ate el cable
aquí
TERMINER
Attacher la
corde ici



Movable Pulley

Polea móvil

Poulie déplaçable

Note: Use the **front view** of the Pulley Stand to work with the Movable Pulley.

Nota: Use the **vista frontal** del soporte de la polea para trabajar con la polea móvil.

Note : Utiliser l'**image avant** de la longueur de poulie pour travailler avec une poulie déplaçable.

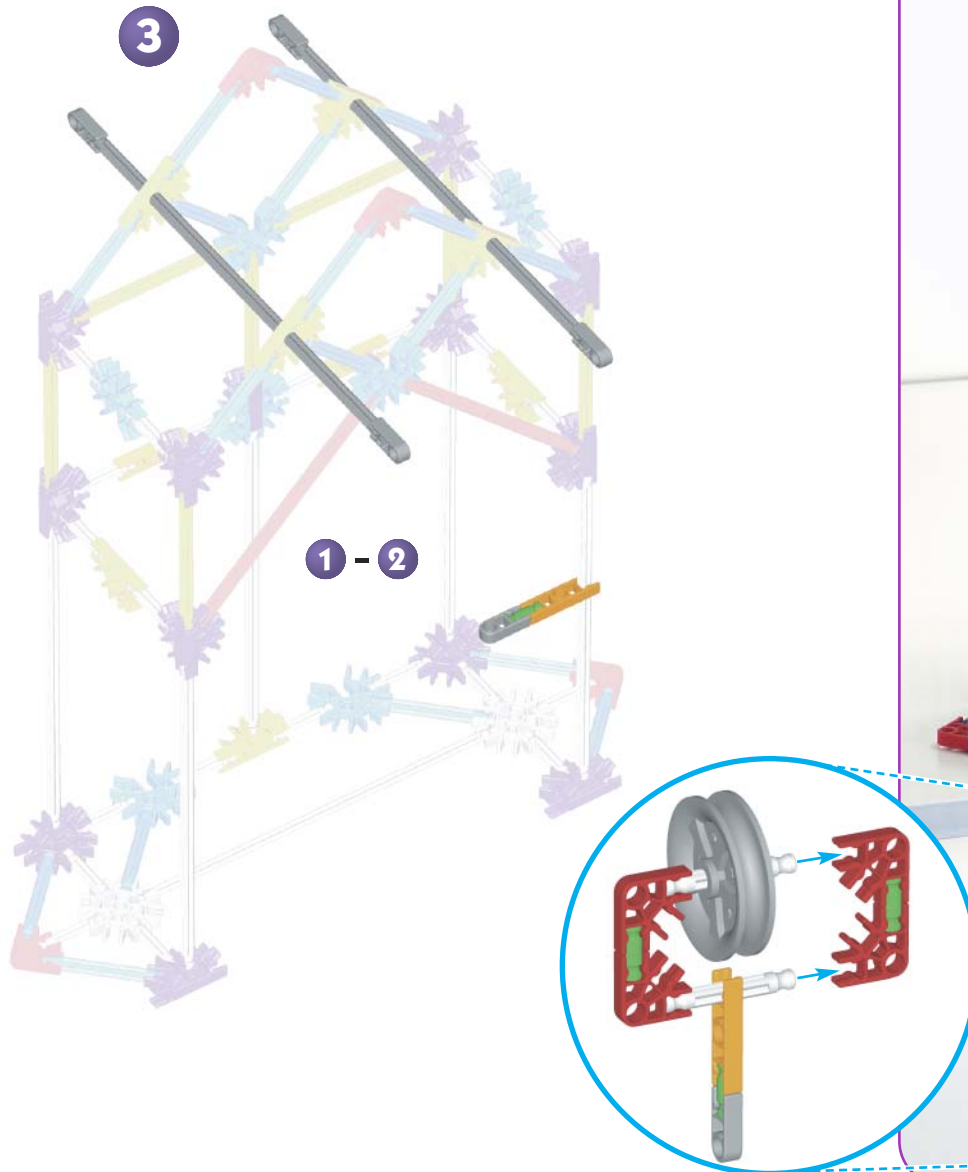

Combination Pulley

Polea de Combinación

Poulie combinée

Note: Use the **front view** of the Pulley Stand to work with the Combination Pulley.

Nota: Use la **vista frontal** del soporte de la polea para trabajar con la polea de Combinación.

Note : Utiliser l'**image avant** de la longueur de poulie pour travailler avec une combinaison de poulie.

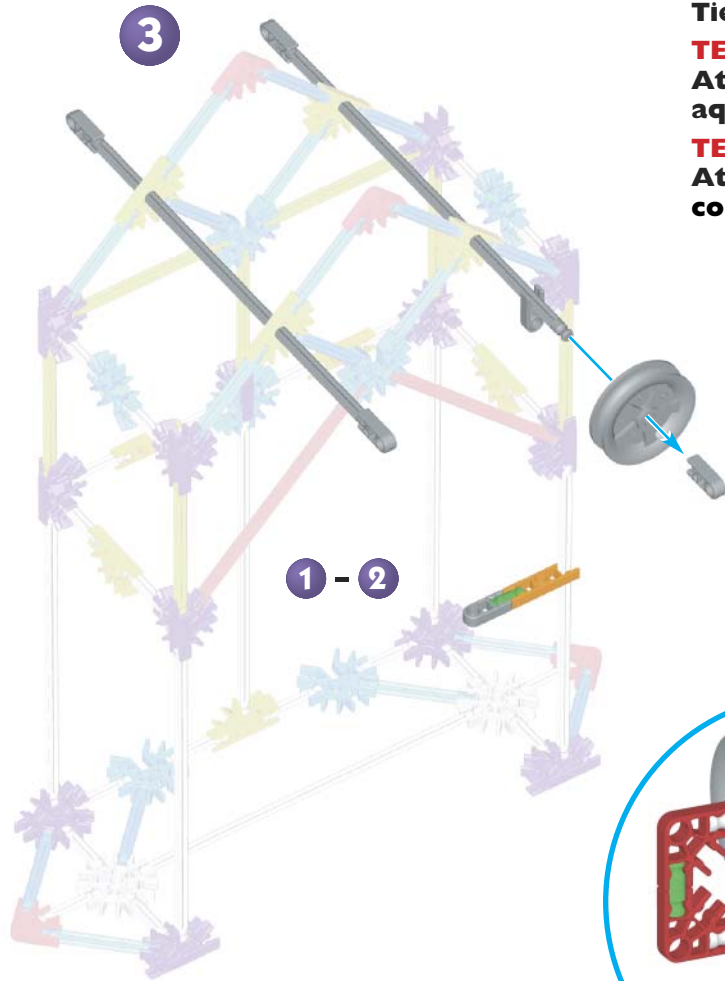

FINISH
Tie cord here
TERMINAR
Ate el cable
aquí
TERMINER
Attacher la
corde ici

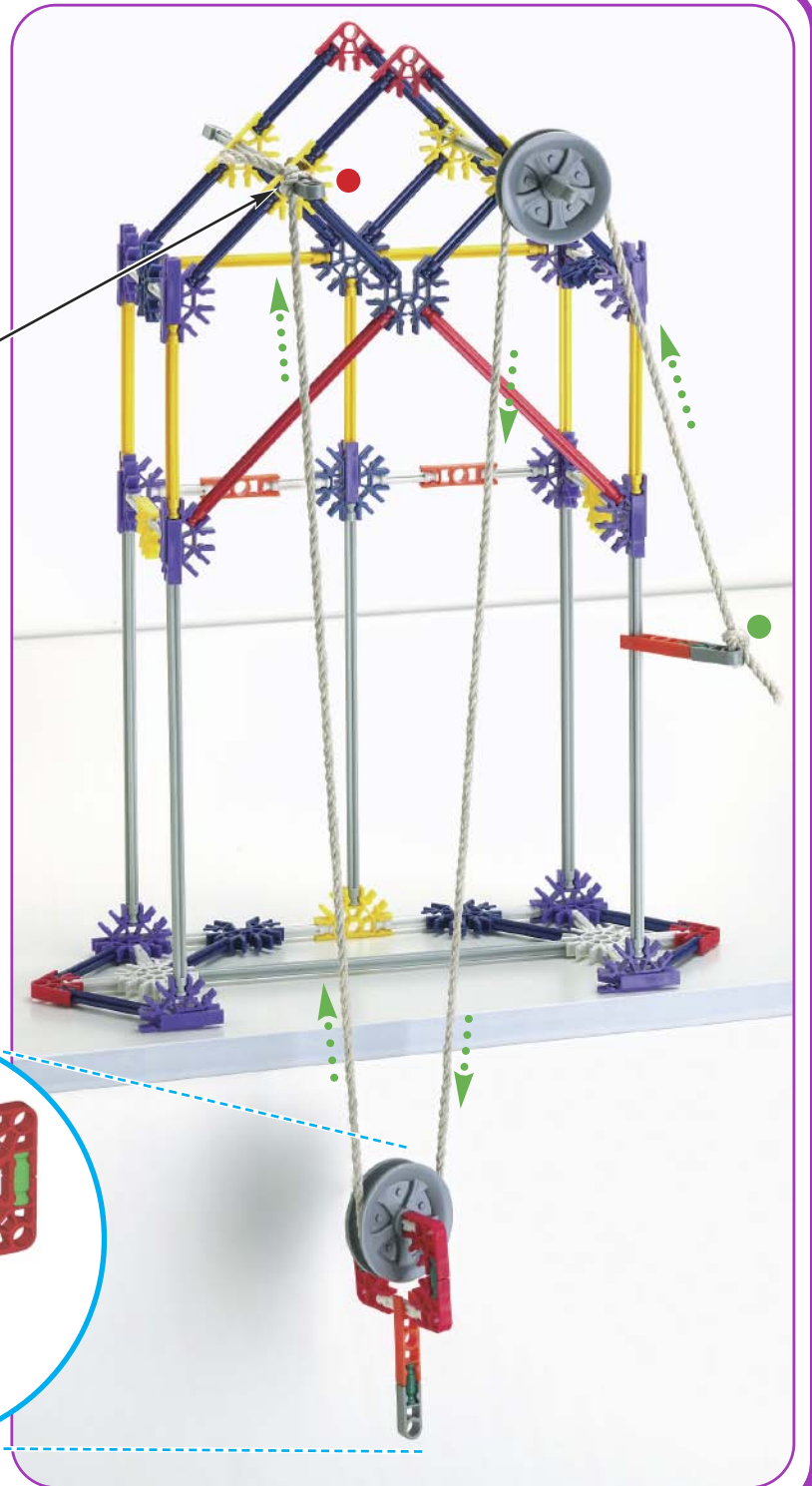
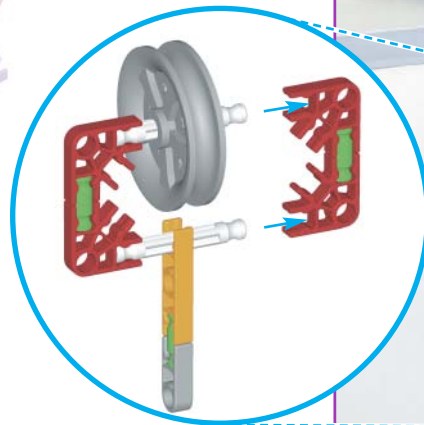

Flagpole Varilla Mât de drapeau

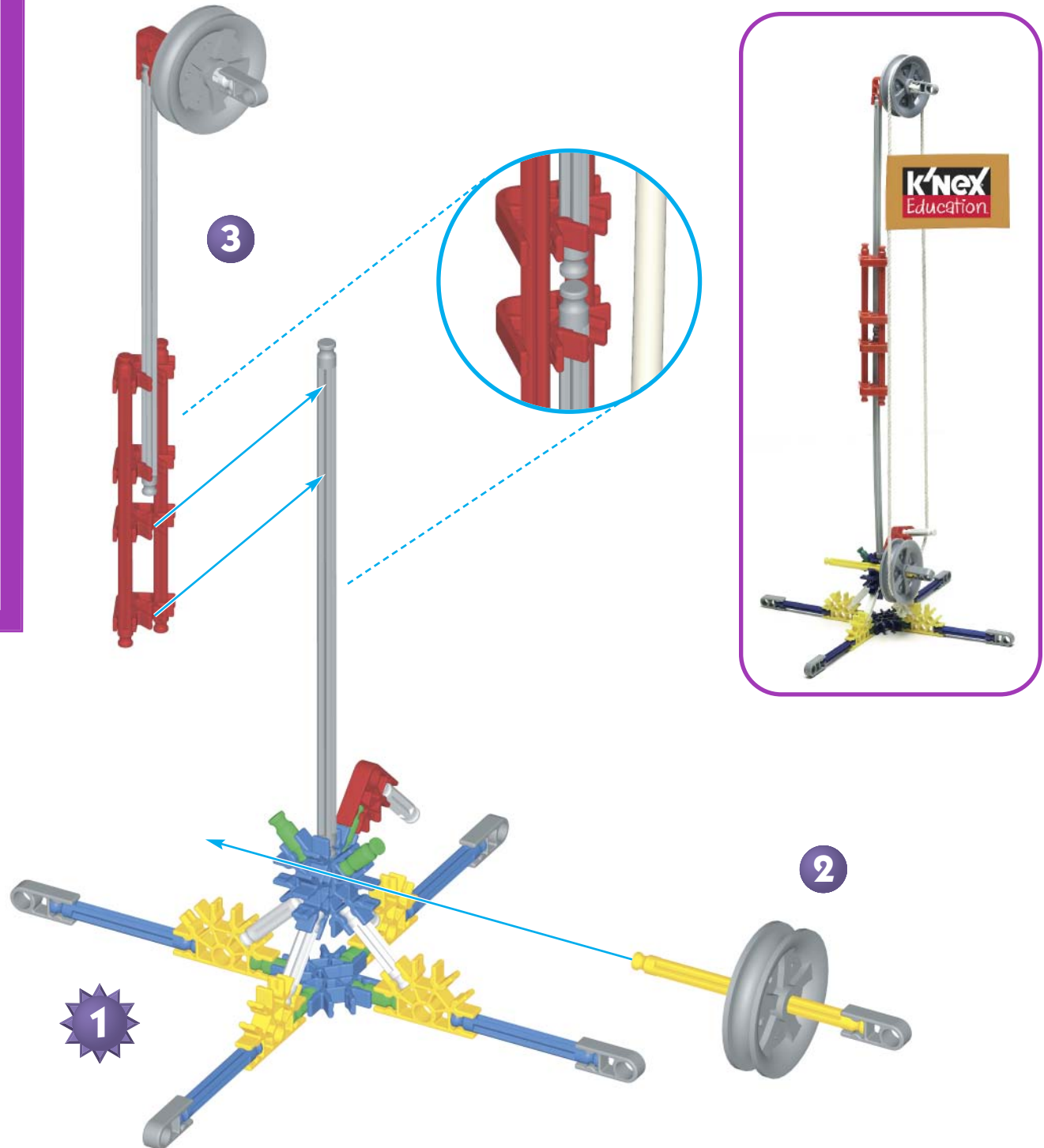
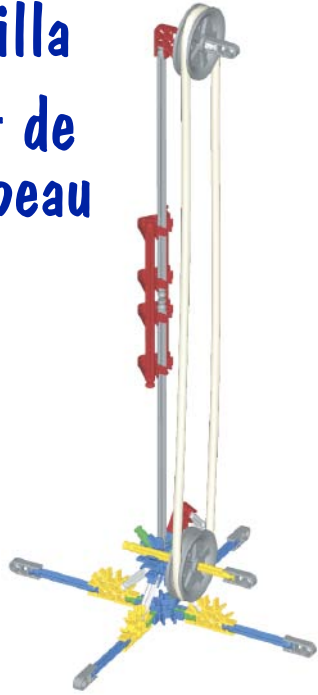

K'NEX Education

| | | | | | |
|---|--|---|--|---|--|
| 6 | | 7 | | 2 | |
| 6 | | 6 | | 1 | |
| 4 | | 4 | | | |
| 3 | | 1 | | | |
| | | 2 | | | |
| | | 2 | | | |

Sailboat

Velero

Bateau à voile

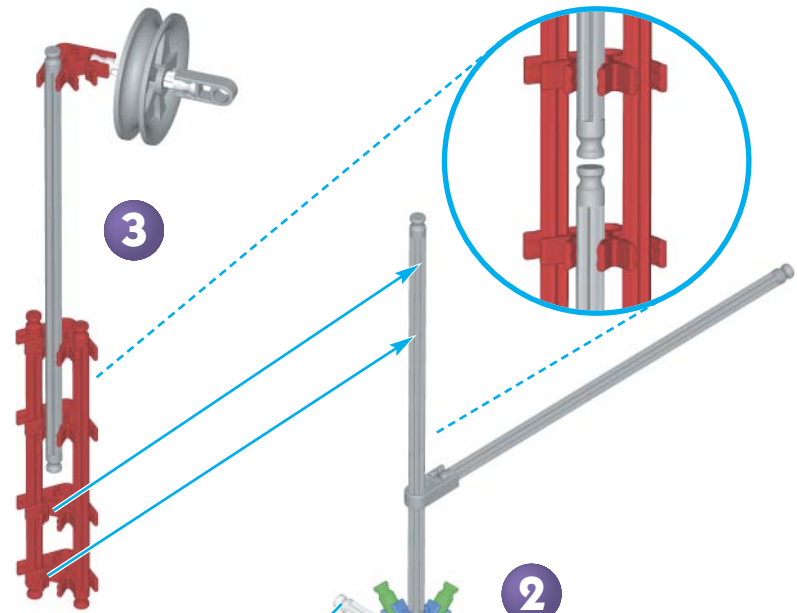

K'nex Education

| | | | | | |
|---|---|----|---|---|--|
| 6 | ▬ | 4 | ▬ | 1 | |
| 9 | | 11 | ▬ | 1 | |
| 7 | | 7 | ▬ | | |
| 8 | | 5 | ▬ | | |
| 2 | | 4 | ▬ | | |
| | | 7 | ▬ | | |

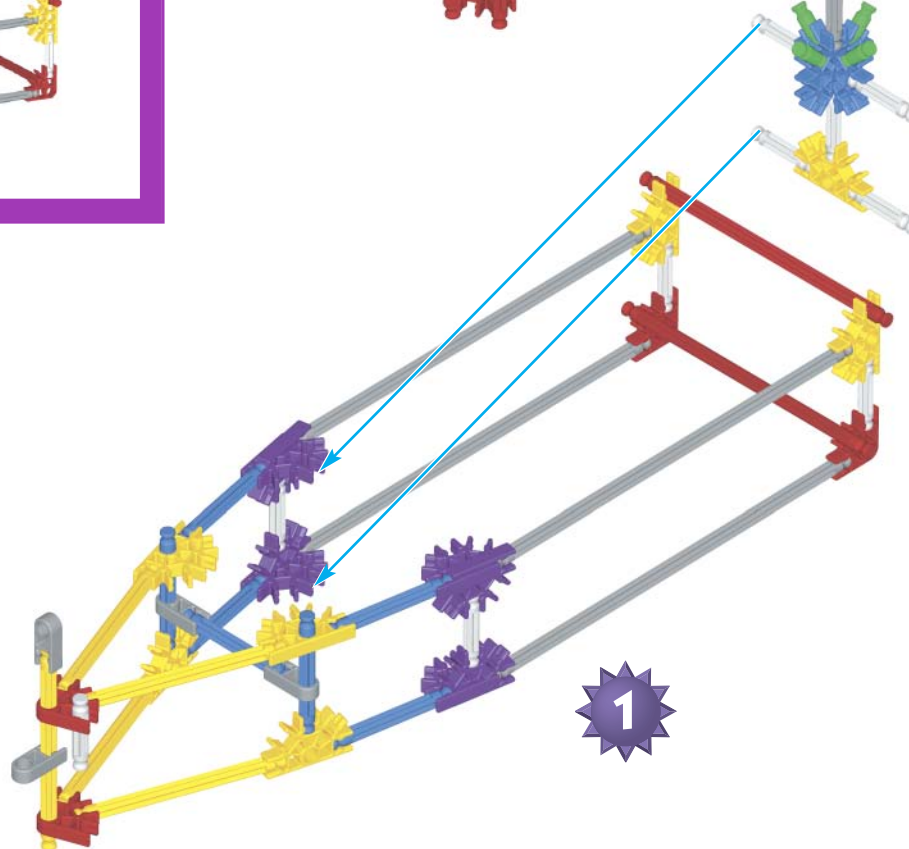

Clothesline Tendedero Corde à linge







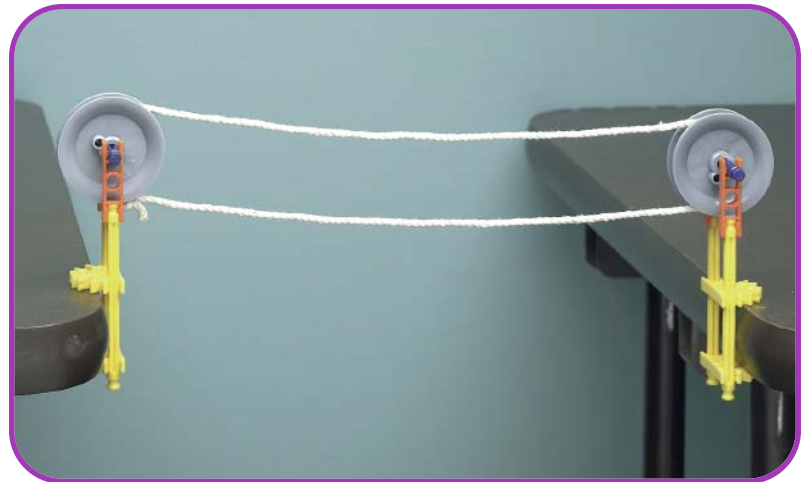
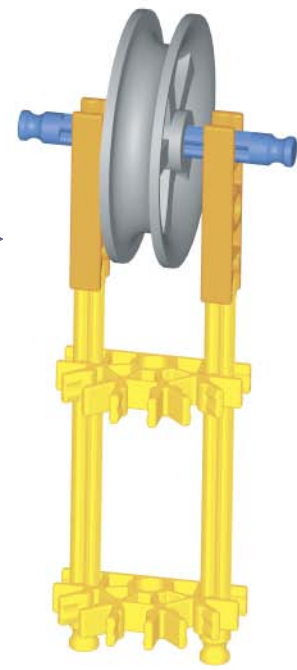

2



1



K'NEX Education

| | | | | | |
|---|---|---|---|---|---|
| 4 |  | 2 |  | 2 |  |
| 4 |  | 4 |  | 1 |  |

Elevator Ascenseur Ascensor

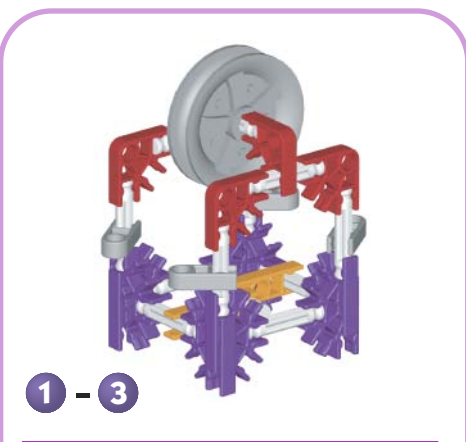
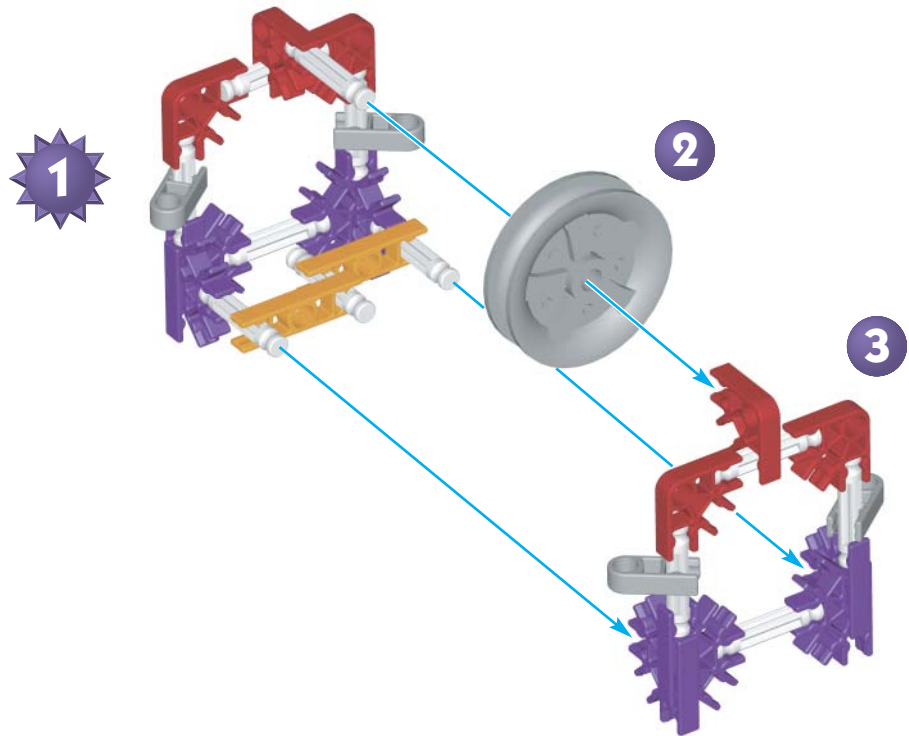

1 - 3

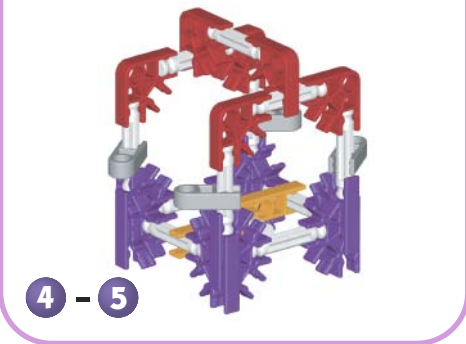

4 - 5

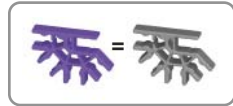

K'NEX Education

| | | | | | |
|----|--|----|--|---|--|
| 14 | | 14 | | 3 | |
| 4 | | 24 | | 2 | |
| 12 | | 18 | | | |
| 12 | | 4 | | | |
| 32 | | 8 | | | |
| 8 | | | | | |
| 2 | | | | | |

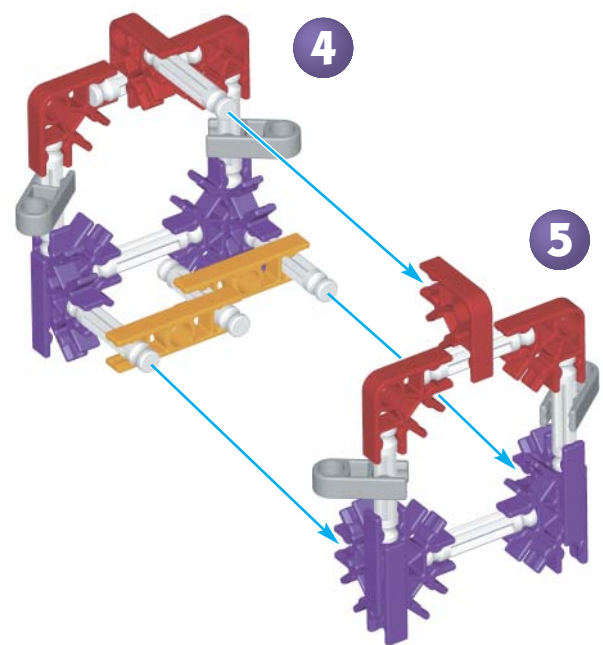

4

5

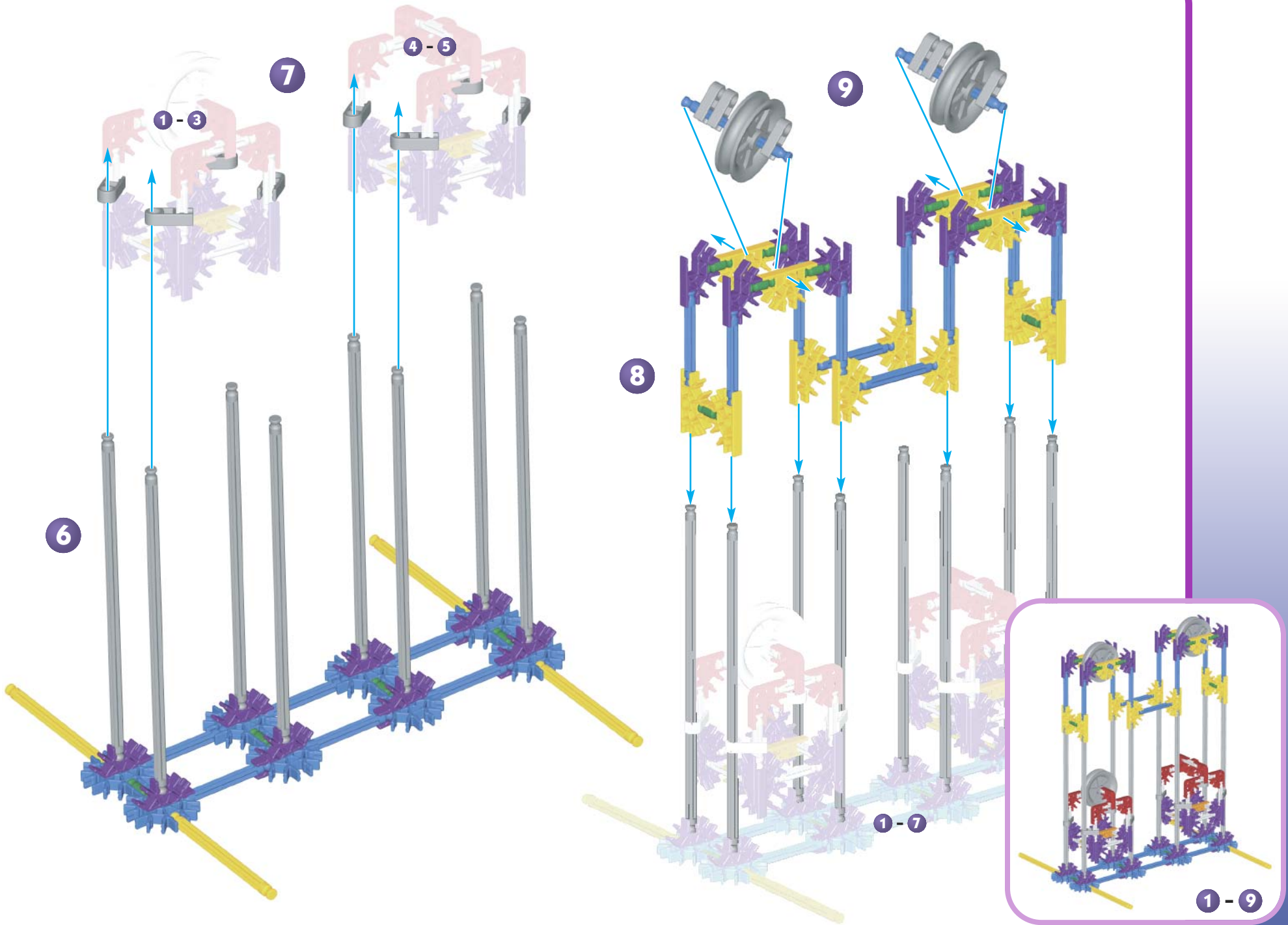

FINISH

Tie cord around a white Connector as shown.

TERMINAR

Ate el cable alrededor del conector blanco como se muestra.

TERMINER

Attacher la corde autour du connecteur blanc comme montré.

START

Tie end of cord to gray Connector.

COMENZAR

Ate el extremo del cable al conector gris.

COMMENCER

Attacher le bout de la corde au connecteur gris.

FINISH

Tie cord around a white Connector as shown.

TERMINAR

Ate el cable alrededor del conector blanco como se muestra.

TERMINER

Attacher la corde autour du connecteur blanc comme montré.

START

Tie end of cord around white Rod.

COMENZAR

Ate el extremo del cable alrededor de la varilla blanca

COMMENCER

Attacher le bout de la corde autour de la barre de relevage blanche.

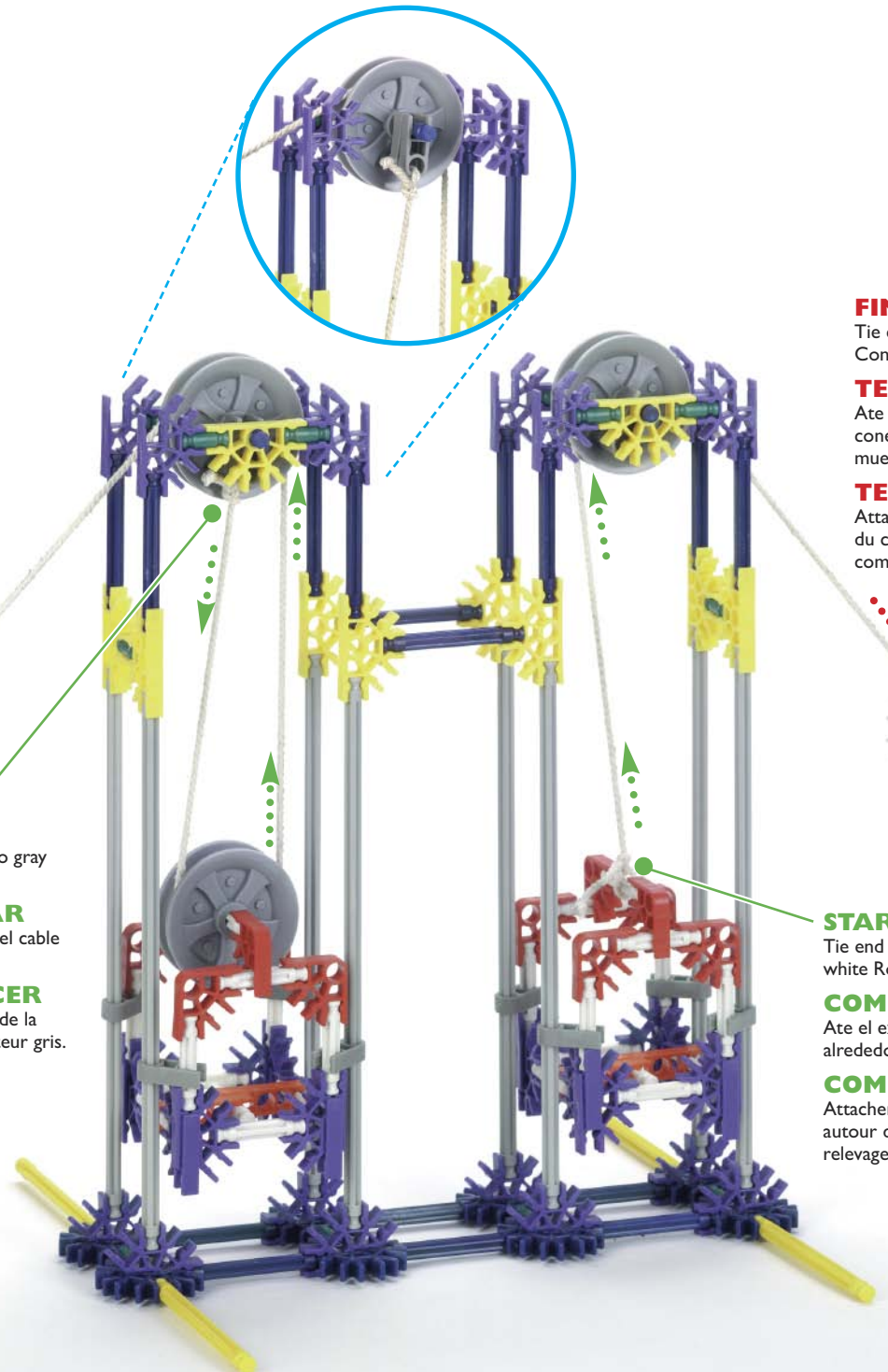

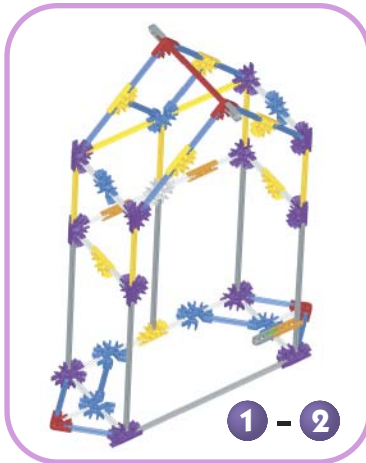
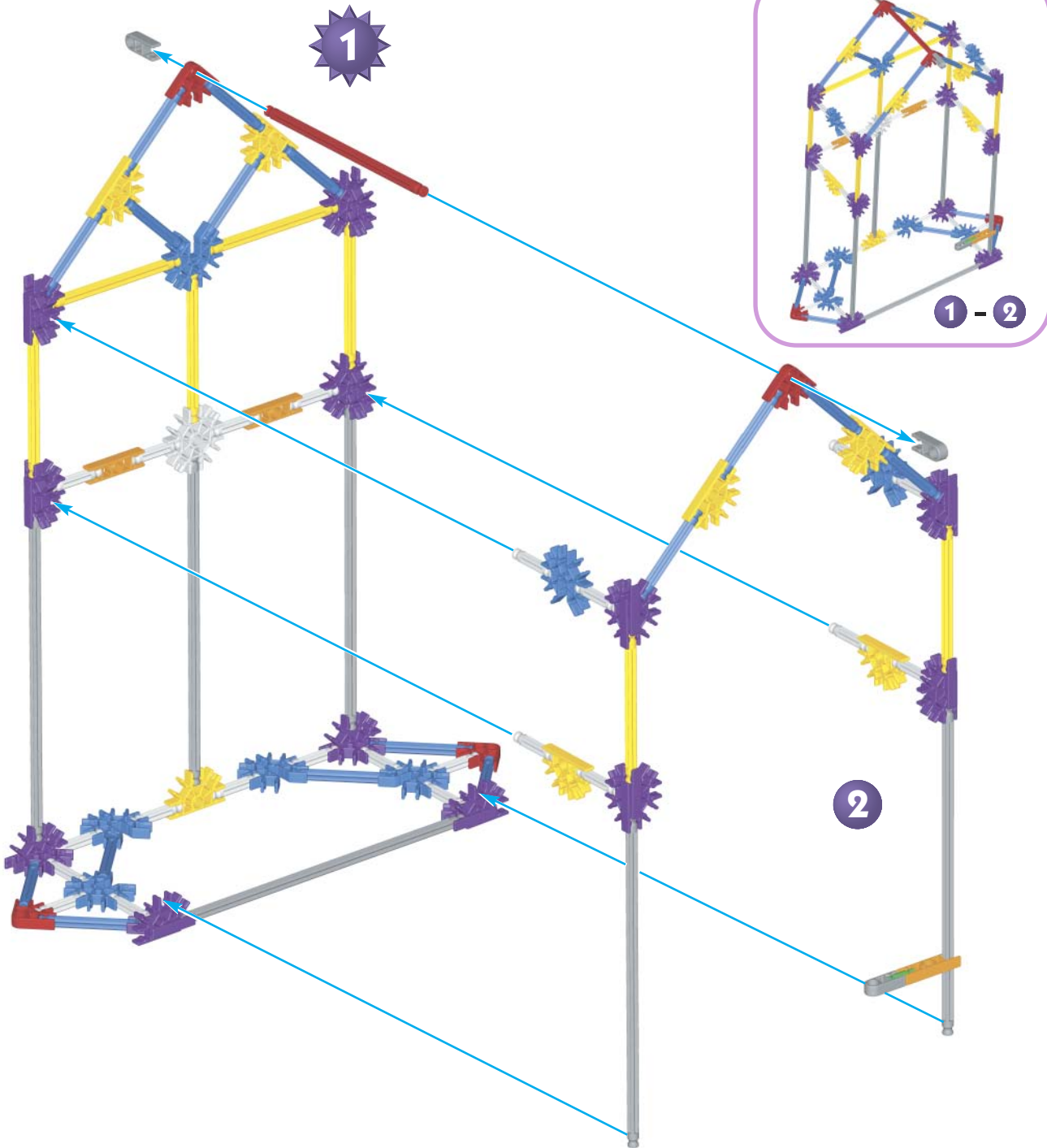

Block & Tackle
Aparejo de poleas

Bloc et palan

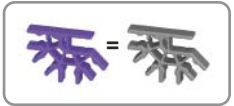

K'NEX Education

- | | | | | | |
|----|--|----|--|---|--|
| 14 | | 19 | | 5 | |
| 6 | | 24 | | 1 | |
| 16 | | 31 | | | |
| 6 | | 7 | | | |
| 12 | | 3 | | | |
| 24 | | 6 | | | |
| 8 | | | | | |
| 3 | | | | | |

3
Pulley A
Polea A
Poulie A

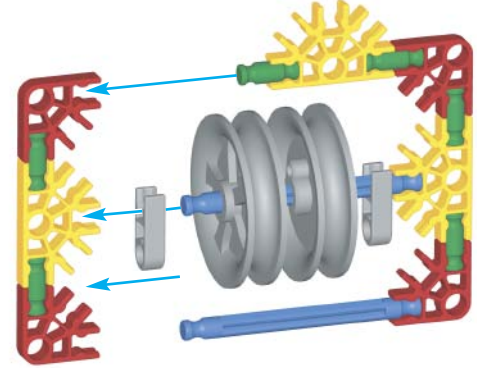

4
Pulley B
Polea B
Poulie B

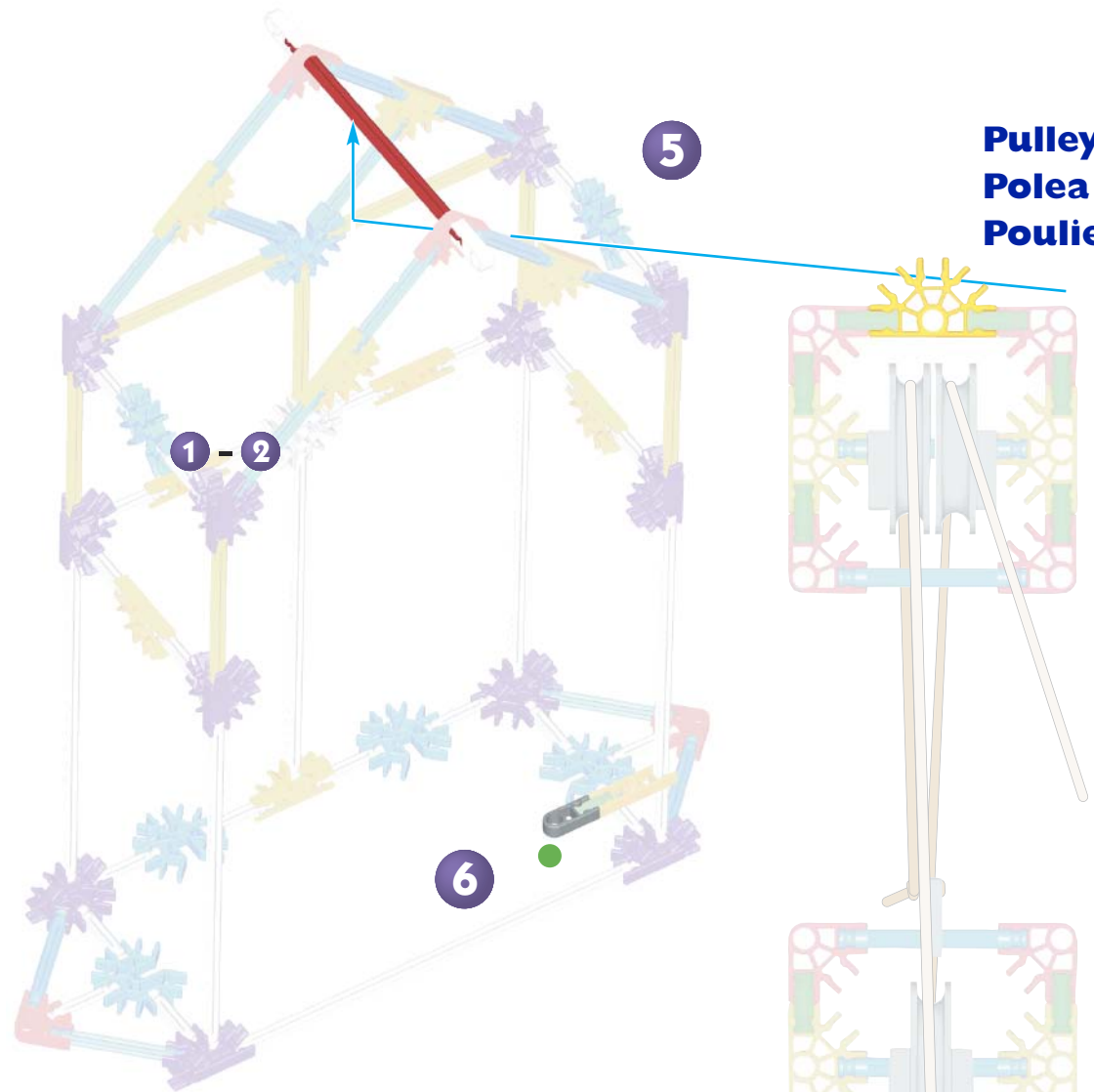
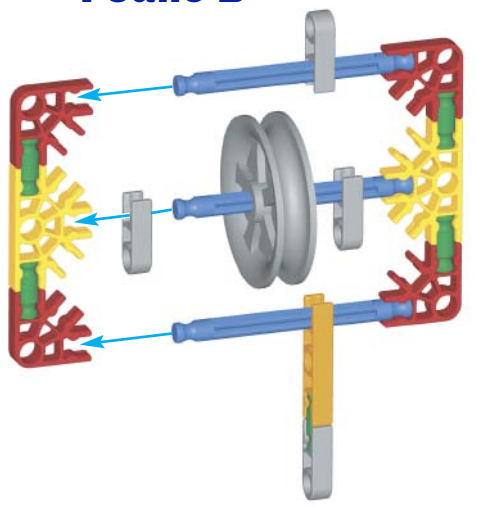

5
Pulley A
Polea A
Poulie A

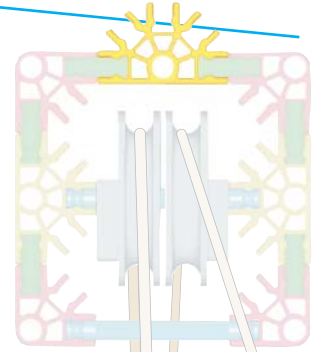

Pulley B
Polea B
Poulie B

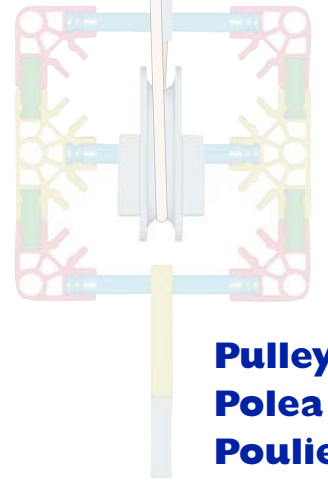

- Attach Pulley A to frame (step #5).
- Tie one end of cord to gray Connector (step #6).
- Complete wrapping cord around Pulley B as shown in diagram.
- Tie cord onto gray Connector on Pulley B.

- Adjunte la Polea A la estructura (paso #5).
- Ate un extremo del cable al conector gris (paso #6).
- Envuelva completamente el cable alrededor de la Polea B como se muestra en el diagrama.
- Ate el cable alrededor al conector gris en la Polea B.

- Attacher la poulie A au cadre (étape #5).
- Attacher un bout de la corde au connecteur gris (étape #6).
- Finir d'envelopper la corde autour de la poulie B comme montrée sur le dessin.
- Attacher la corde sur le connecteur gris de la poulie B.

How to String Cómo atar Comment corder

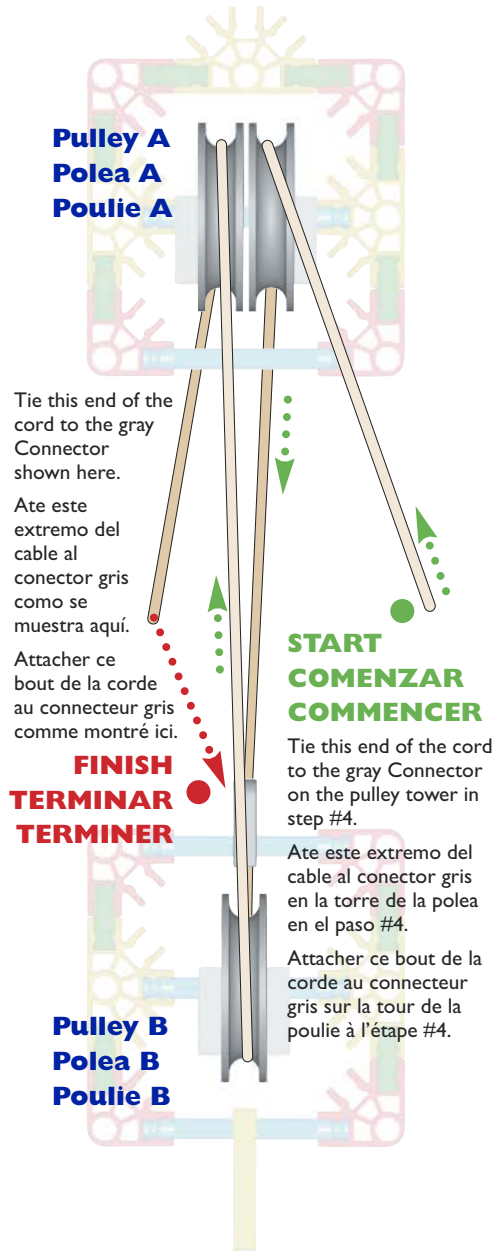

Try these other Pulley Configurations Pruebe estas otras configuraciones de la polea Essayer ces autres configurations de poulies

- **START CORD**
COMENZAR CABLE
COMMENCER LA CORDE
- **FINISH CORD**
TERMINAR CABLE
TERMINER LA CORDE

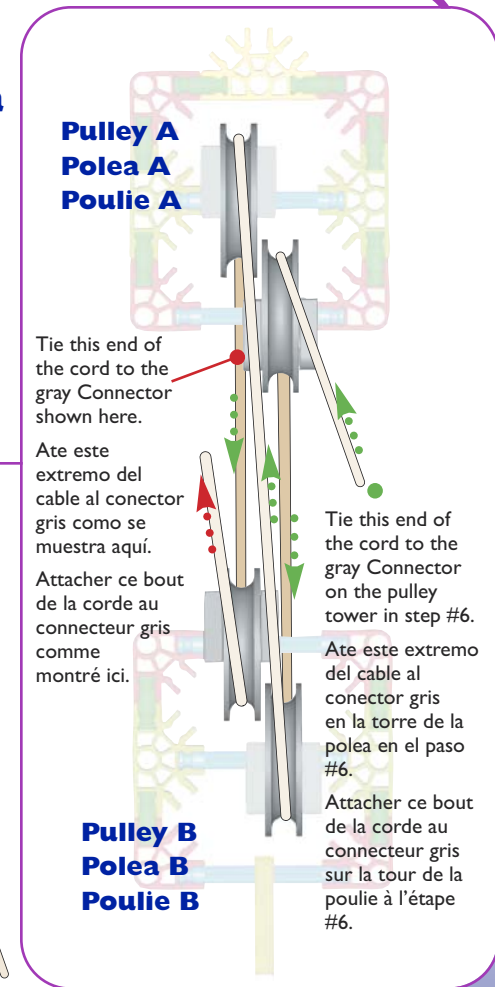
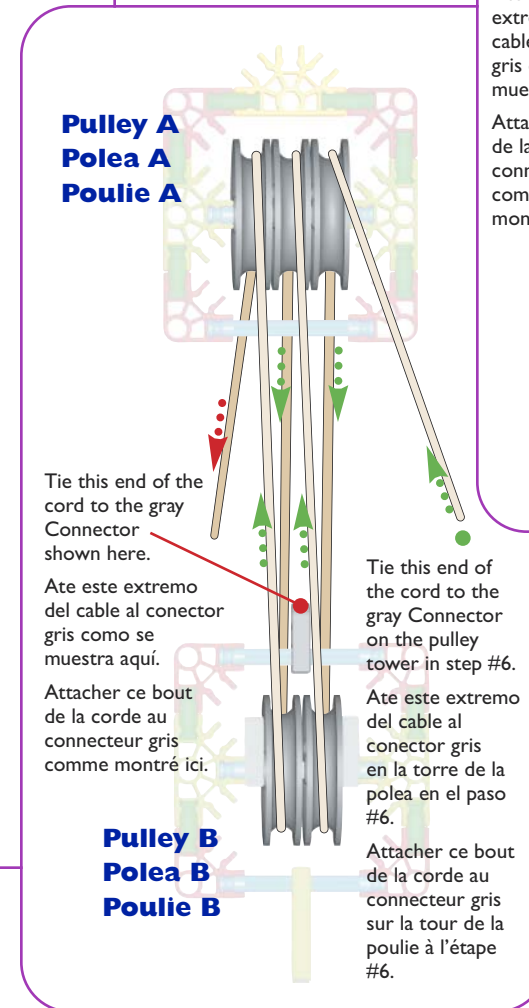
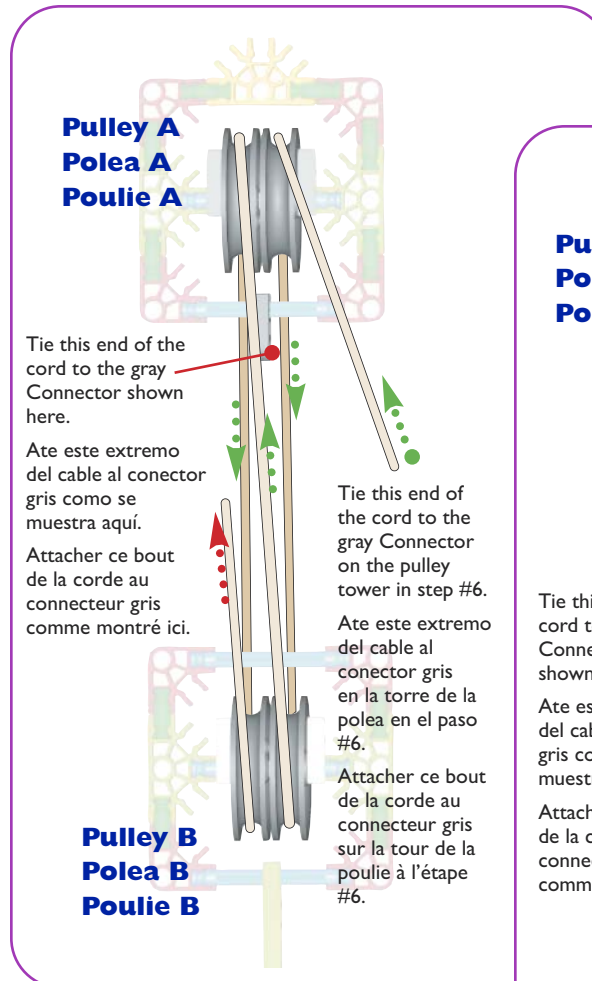

Add frame front
Añada la parte delantera del marco
Ajouter le cadre avant



8

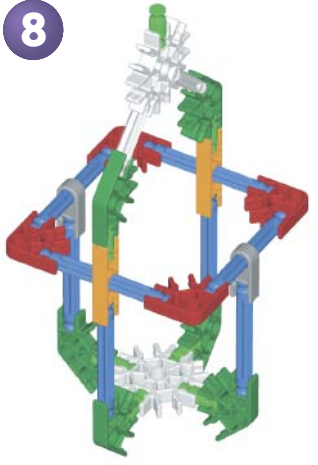

Place a cup of pennies in bucket for weight.
 Coloque una taza de monedas de un centavo en el cubo para pesar.
 Placer quelques sous dans le bac pour vérifier le poids.



Crane Grúa Grue



K'NEX Education

| | | | | | |
|----|--|----|--|---|--|
| 15 | | 12 | | 5 | |
| 3 | | 18 | | 2 | |
| 12 | | 21 | | 5 | |
| 9 | | 5 | | 2 | |
| 24 | | 2 | | 5 | |
| 8 | | 5 | | | |

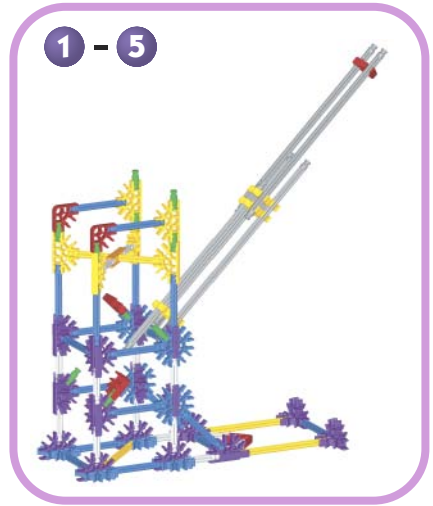
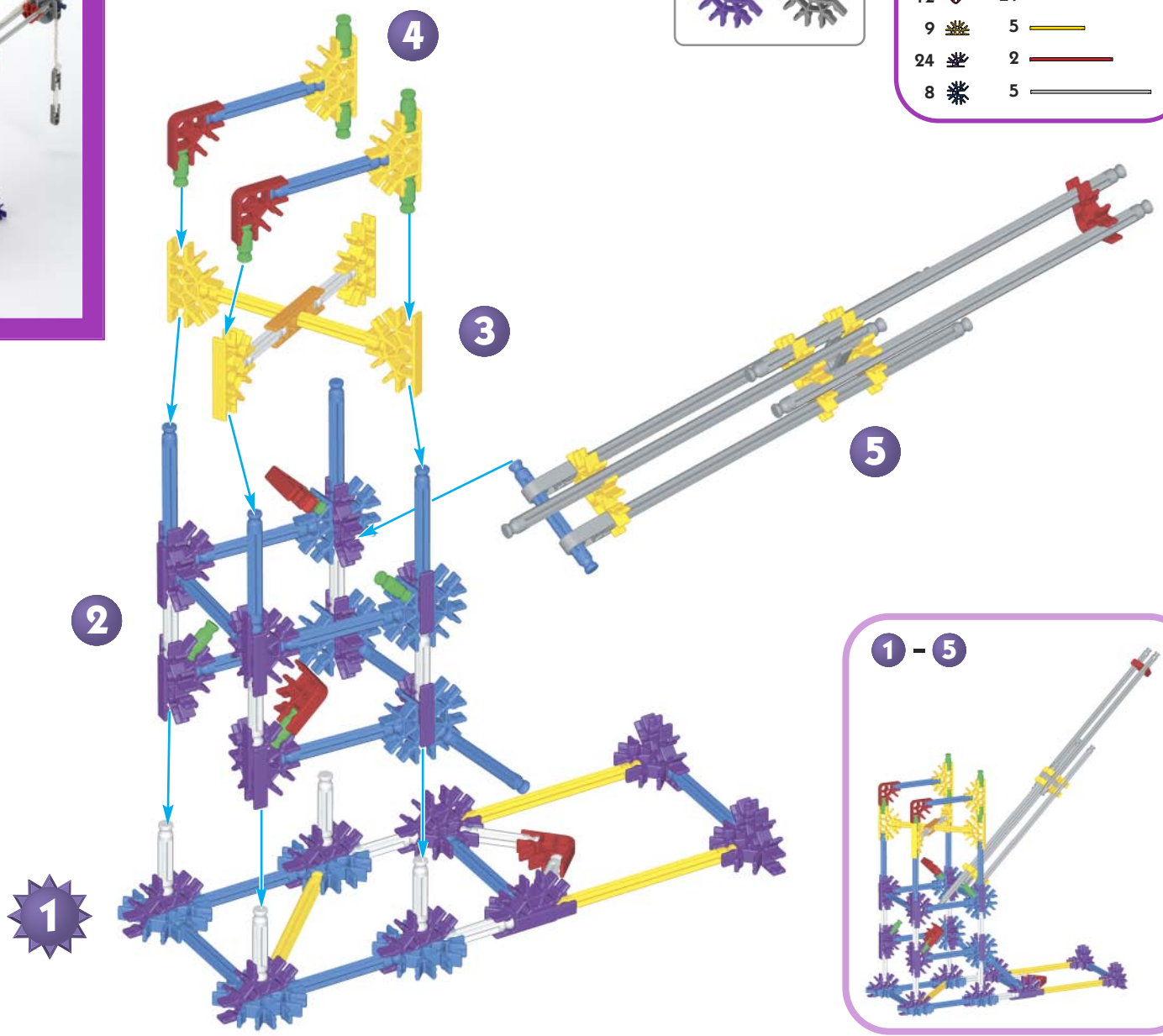

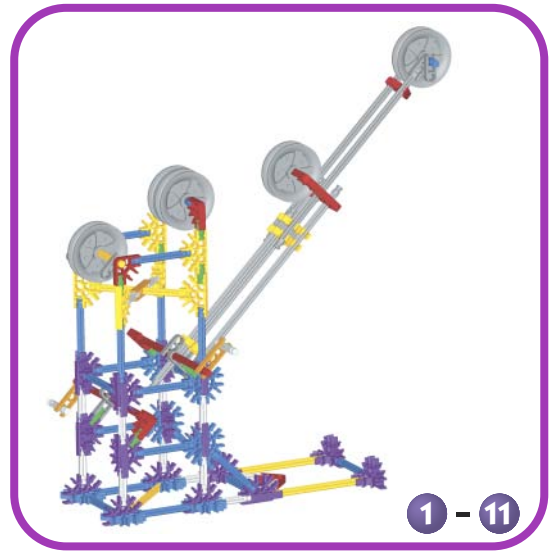
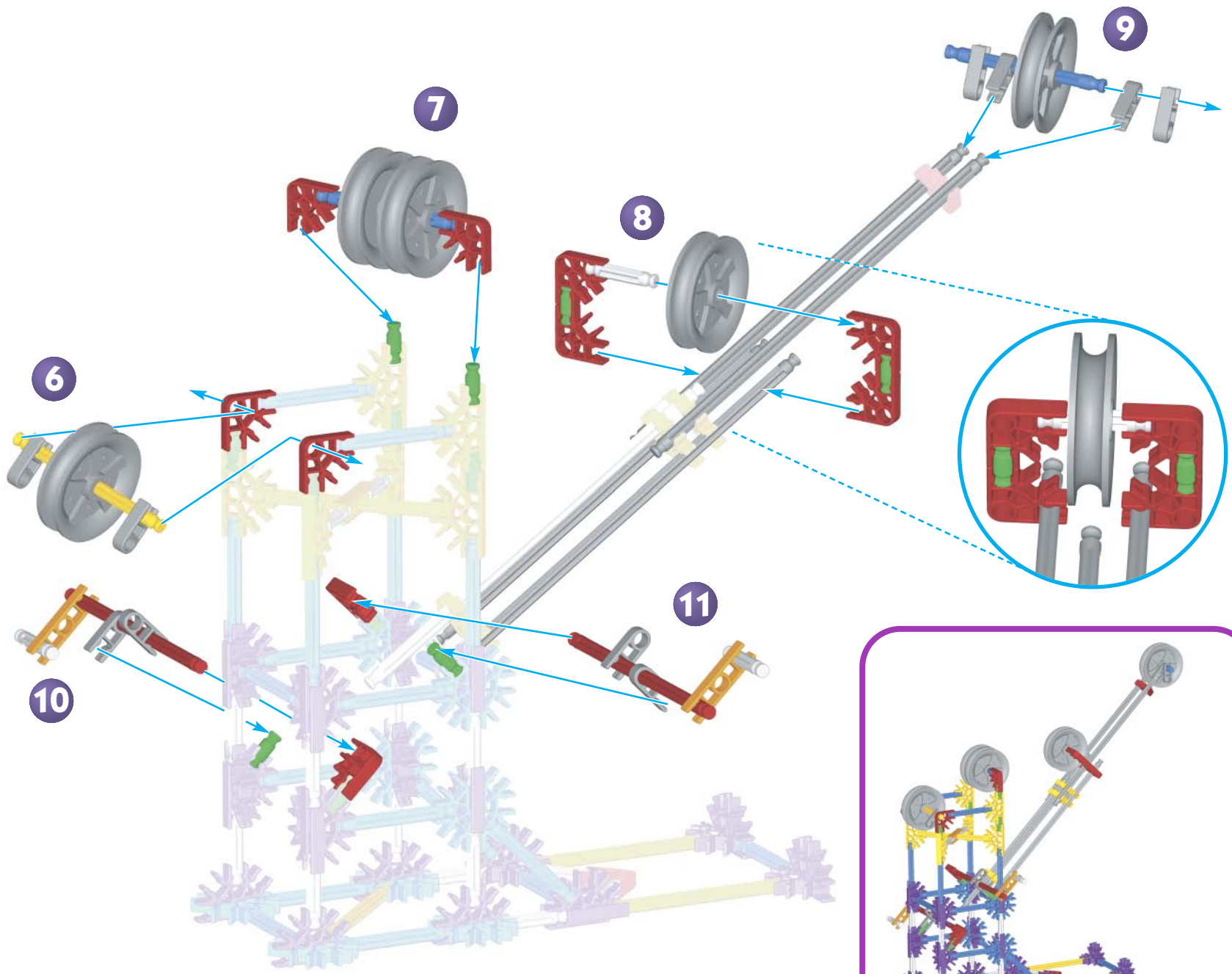

How to String 1st Cord
Cómo atar el 1er cable
Comment corder la première corde

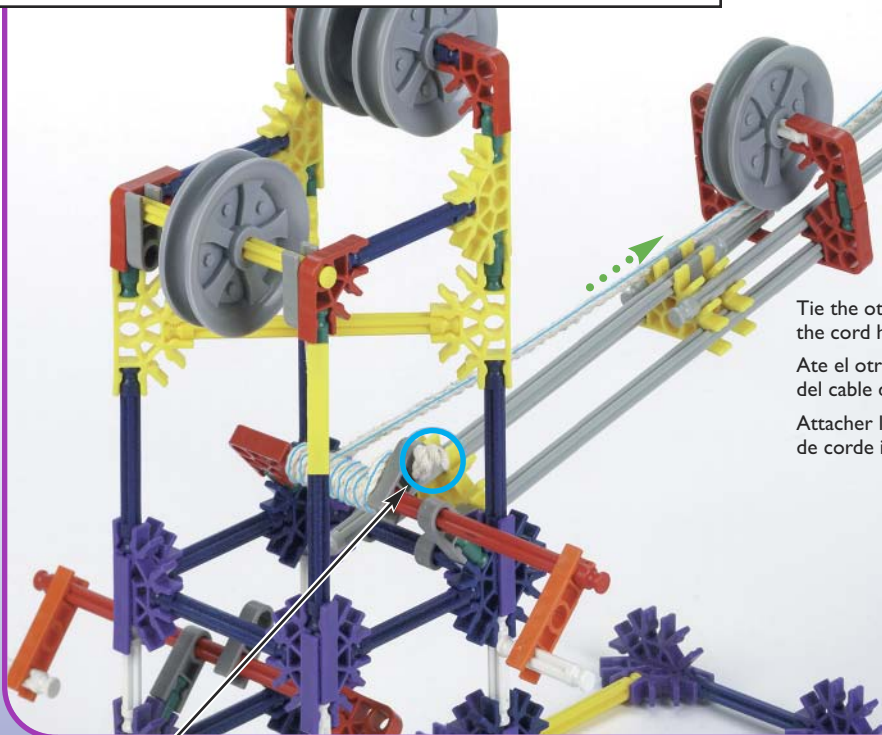

Tie the other end of the cord here.
 Ate el otro extremo del cable de aquí.
 Attacher l'autre bout de corde ici.

Color Key
Clave de colores
Couleur de la clé

- | | |
|--|---|
| ■ Cord 1 | ■ Cord 2 |
| Cable 1 | Cable 2 |
| Corde 1 | Corde 2 |

How to String 2nd Cord
Cómo atar el segundo cable
Comment corder la second corde

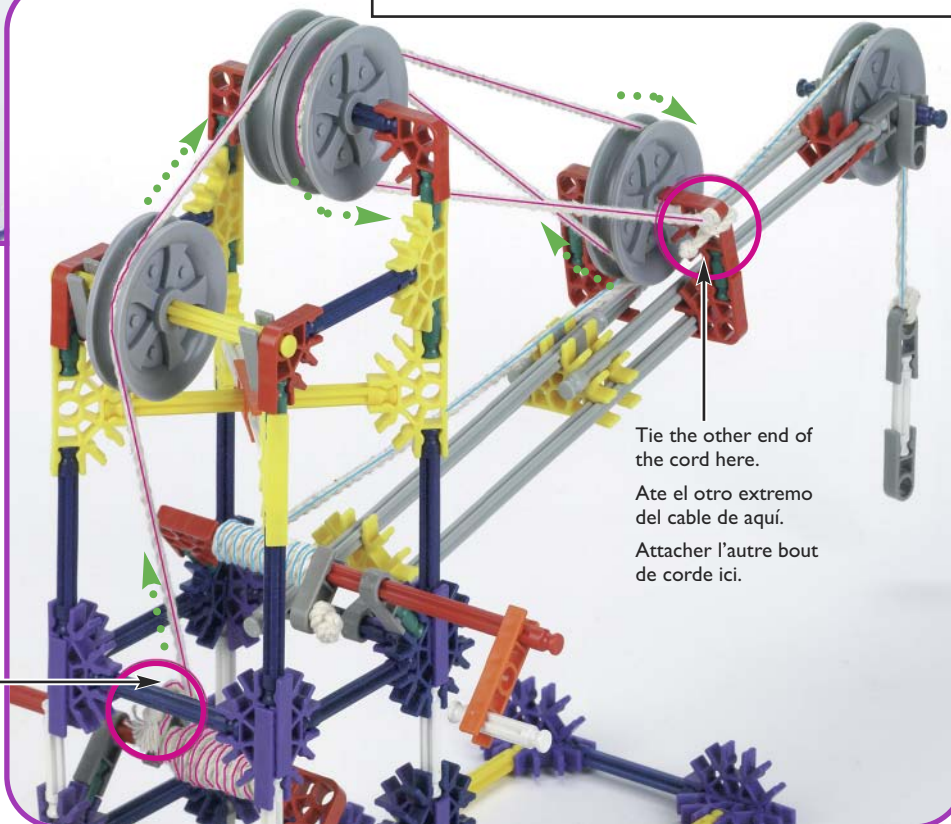

Tie the other end of the cord here.
 Ate el otro extremo del cable de aquí.
 Attacher l'autre bout de corde ici.

START

Tie one end of the cord through the hole on gray Connector.

COMENZAR

Ate un extremo del cable a través del agujero del conector gris.

COMMENCER

Attacher un bout de corde dans le trou du connecteur gris.

START

Tie one end of the cord through the hole on gray Connector.

COMENZAR

Ate un extremo del cable a través del agujero del conector gris.

COMMENCER

Attacher un bout de corde dans le trou du connecteur gris.

PULLEYS – Parts List
POLEAS – Lista de Partes
POULIES – Liste de Pièces

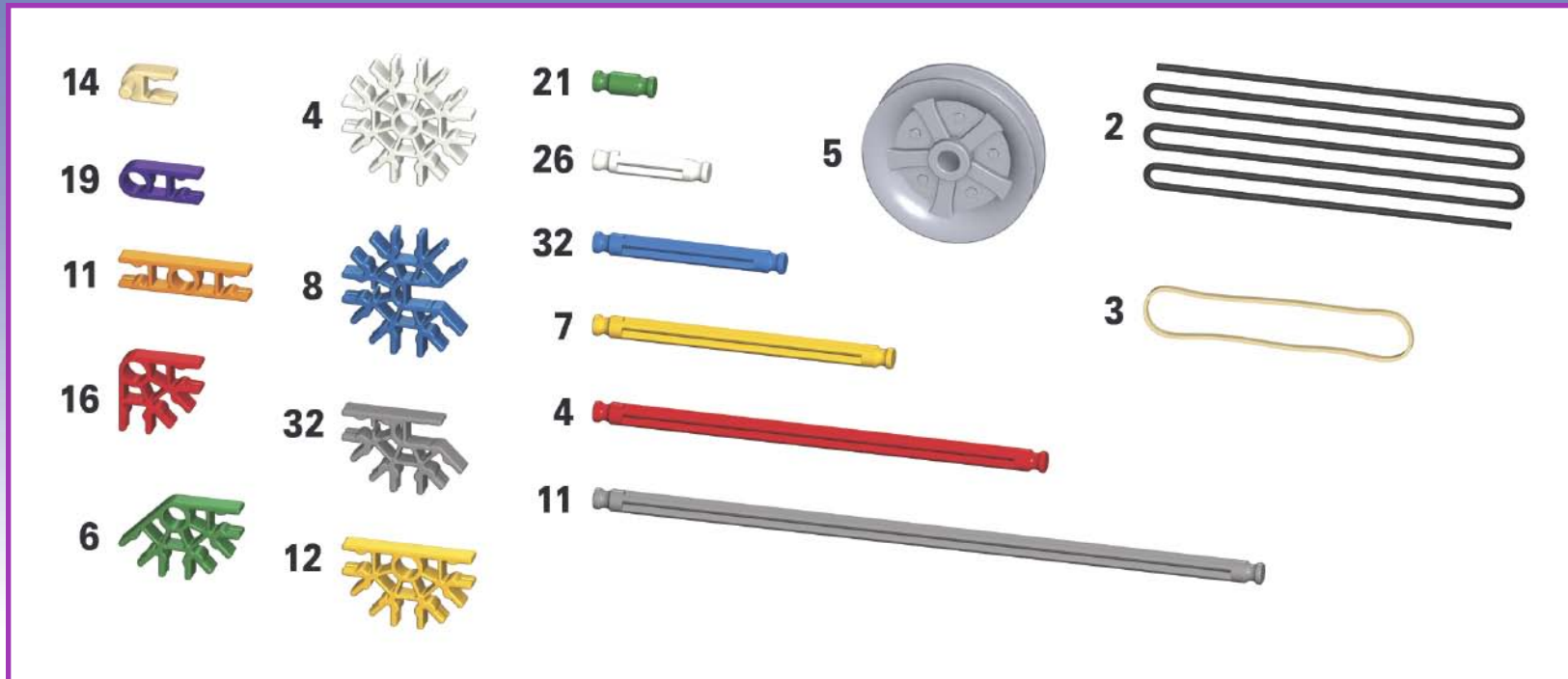

Product and colors may vary.
 K'NEX is a registered trademark of K'NEX Limited Partnership Group.

El producto y los colores podrán variar.
 K'NEX es una marca registrada de K'NEX Limited Partnership Group.

Le produit et les couleurs peuvent varier.
 K'NEX est une marques déposée de K'NEX Limited Partnership Group.

K'NEX Education
 P.O. Box 700
 Hatfield, PA
 19440-0700

1-888-ABC-KNEX
 (USA/Canada/EE.UU./États-Unis)

Email:
 abcknex@knex.com

©2011 K'NEX Limited Partnership Group



17952002.11-V1-11/10